

深圳市昱申科技有限公司
CHINA YOUNG SUN LED TECHNOLOGY CO., LTD.

TEL: (86) 755-28079401 28079402 28079403 28079404 28079405
FAX: (86) 755-28079407 E-mail: info@100LED.com Web: www.100LED.com

Model No.: YSL-R1042G2C-D16

Applications:

- Decorations
- Advertising Sign
- Indicators
- Illuminations
- Traffic Lights
- Flashlights

Absolute Maximum Ratings: (Ta=25°C) .

ITEMS	Symbol	Absolute Maximum Rating	Unit
Forward Current	I _F	80	mA
Peak Forward Current	I _{FP}	120	mA
Suggestion Using Current	I _{SU}	65-75	mA
Reverse Current (V _R =5V)	I _R	10	uA
Power Dissipation	P _D	180	mW
Operation Temperature	T _{OPR}	-40 ~ 85	°C
Storage Temperature	T _{STG}	-40 ~ 100	°C
Lead Soldering Temperature	T _{SOL}	Max. 260°C for 3 Sec. Max. (3mm from the base of the epoxy bulb)	

Absolute Maximum Ratings: (Ta=25°C)

ITEMS	Symbol	Test condition	Min.	Typ.	Max.	Unit
Forward Voltage	V _F	I _F =80mA	3.0	---	3.4	V
Wavelength (nm) or TC(k)	Δλ	I _F =80mA	515	---	520	NM
*Luminous intensity	I _V	I _F =80mA	16000	---	20000	MCD
50% Viewing Angle	2θ 1/2	I _F =80mA	---	30	---	DEGREE

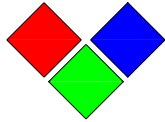

深圳市昱申科技有限公司 CHINA YOUNG SUN LED TECHNOLOGY CO., LTD.

TEL: (86) 755-28079401 28079402 28079403 28079404 28079405
FAX: (86) 755-28079407 E-mail: info@100LED.com Web: www.100LED.com

Mechanical Dimensions:

- All dimension are in mm, tolerance is $\pm 0.2\text{mm}$ unless otherwise noted
- An epoxy meniscus may extend about 1.5mm down the leads.
- Burr around bottom of epoxy may be 0.5mm Maximum

Unit: mm

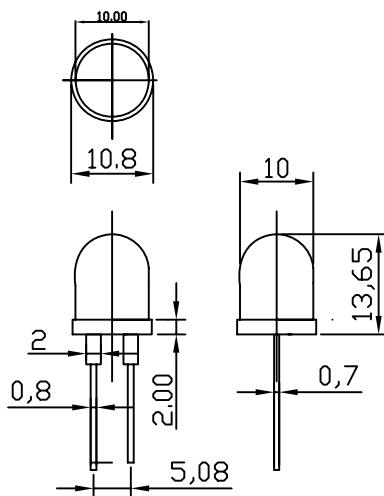

Viewing Angle Drawing

Anode

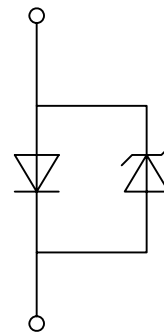

Cathode

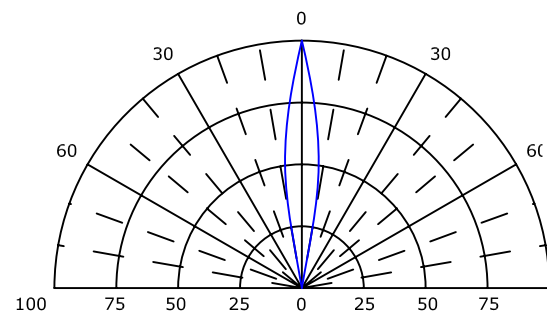

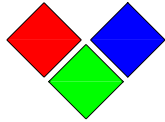

深圳市昱申科技有限公司

CHINA YOUNG SUN LED TECHNOLOGY CO., LTD.

TEL: (86) 755-28079401 28079402 28079403 28079404 28079405

FAX: (86) 755-28079407 E-mail: info@100LED.com Web: www.100LED.com

Code System:

YSL-R1042G2C-D16



1. Company Code, short for Young Sun

2. Code for LED series.

3. Code for LED Type.

4. Code for LED Lens Type.

R: Round B: Bullet C: Columnar O: Oval

H: Helmet Q: Square V: Concave P: Pagoda

S: Strawhat D: Special

5. Code for Lead Frame of LED

6. Code for Lead Frame Code of LED

7. Code for Wavelength Color

8. Code for Lens color

C: Water Clear	W: White Diffused	D: Color Diffused	T: Color Transparent
----------------	-------------------	-------------------	----------------------

9. Code for Viewing Angle

A: 1-10	B: 10-20	C: 20-30	D: 30-40	E: 40-60	F: 60-90	G: 90-120	H: >120
---------	----------	----------	----------	----------	----------	-----------	---------

10. Luminous Intensity Grade:

1: 1-50mcd	4: 200-300mcd	7: 800-1000mcd	10: 2000-3000mcd	14: 10000-13000mcd
2: 50-100mcd	5: 300-500mcd	8: 1000-1500mcd	11: 3000-5000mcd	15: 13000-15000mcd
3: 100-200mcd	6: 500-800mcd	9: 1500-2000mcd	12: 5000-8000mcd	16: 15000-20000mcd
			13: 8000-10000mcd	17: 20000~mcd

Notes:

1. In order to make the life longer, please set the input current below 80mA.

2. Electrical & Optical Characteristics consistency of same items all shipments.

3. Please use LEDs based on our datasheet.

4. LED is sensitive to statics, be sure your equipments are anti-static when you use our LEDs.

5. Pay more attention to your heat dissipation system when you use it, the better heat dissipation, the longer LED lifespan.